

Reserve production notices DIN ISO 9006  
 Reserver Produktionsnotizen DIN ISO 9006  
 is prohibited, unless expressly permitted. Anyone found in breach thereof shall  
 be liable for damages. In case of a patent, utility model or design being registered,  
 all rights are reserved.  
 Schutzrechte DIN ISO 9006 beachten  
 Rechte vorbehalten, sofern nicht ausdrücklich gestattet. Zuwiderhandlungen  
 sind strafbar. In Falle der Patent-, Gebrauchsmuster-  
 oder Geschmacksmustervereintragung vorbehalten.

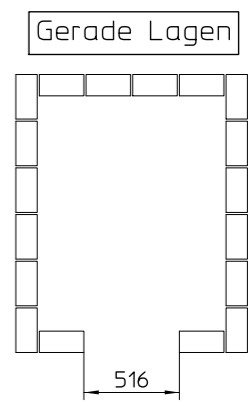
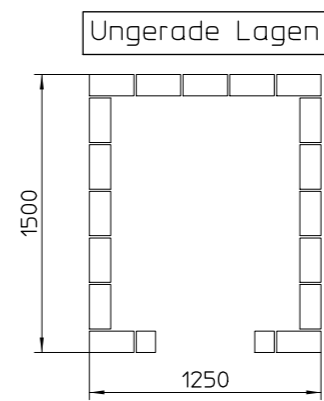
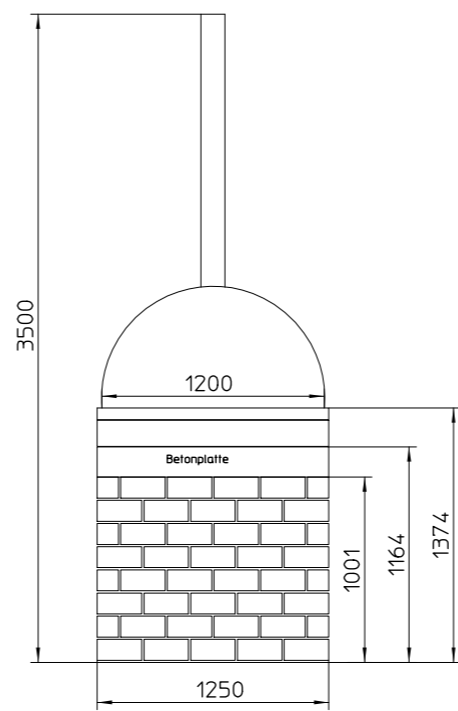
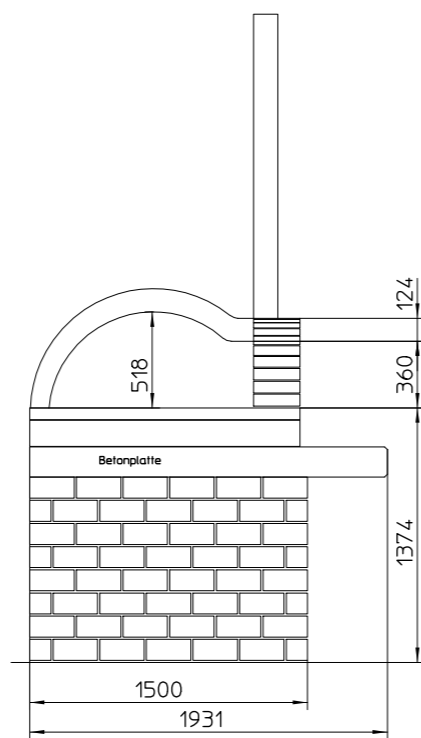
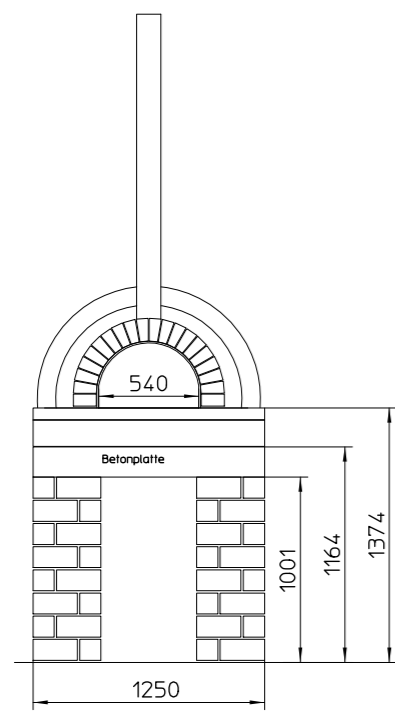
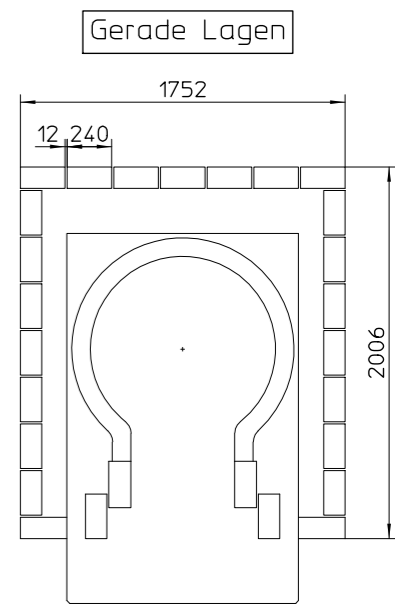
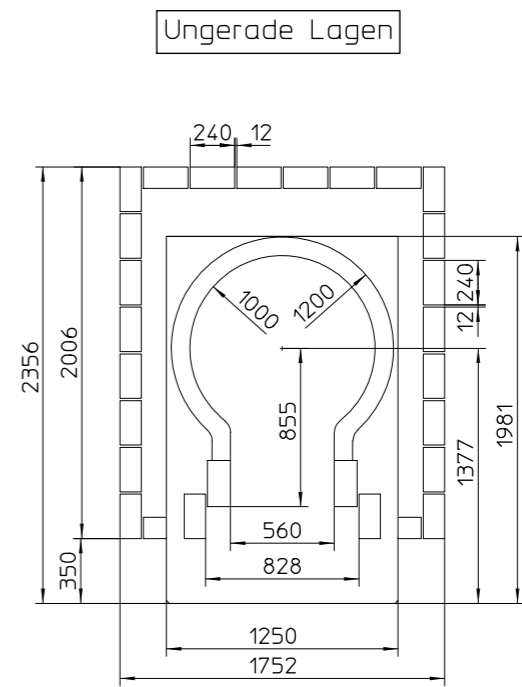
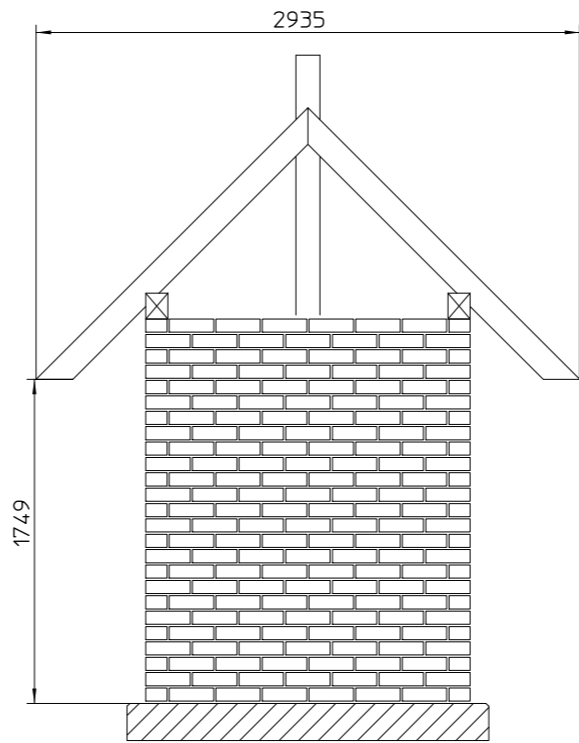
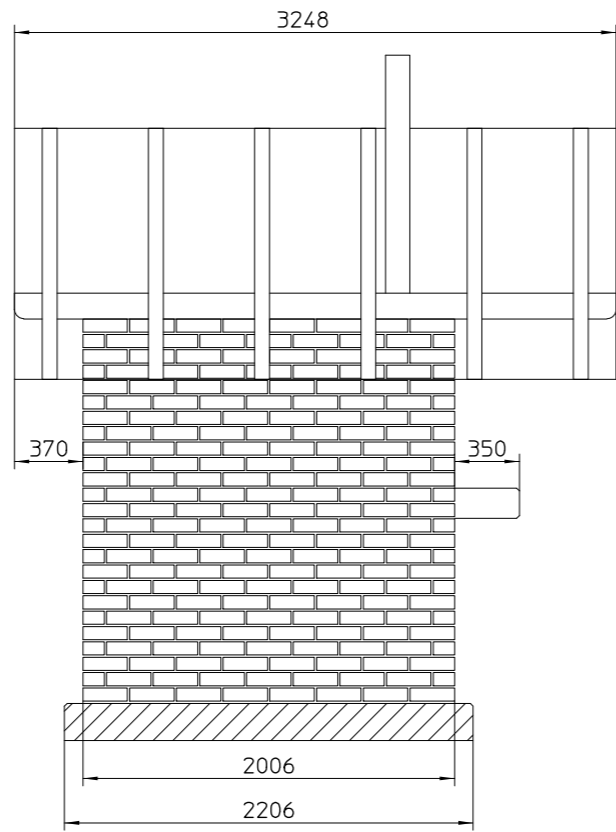
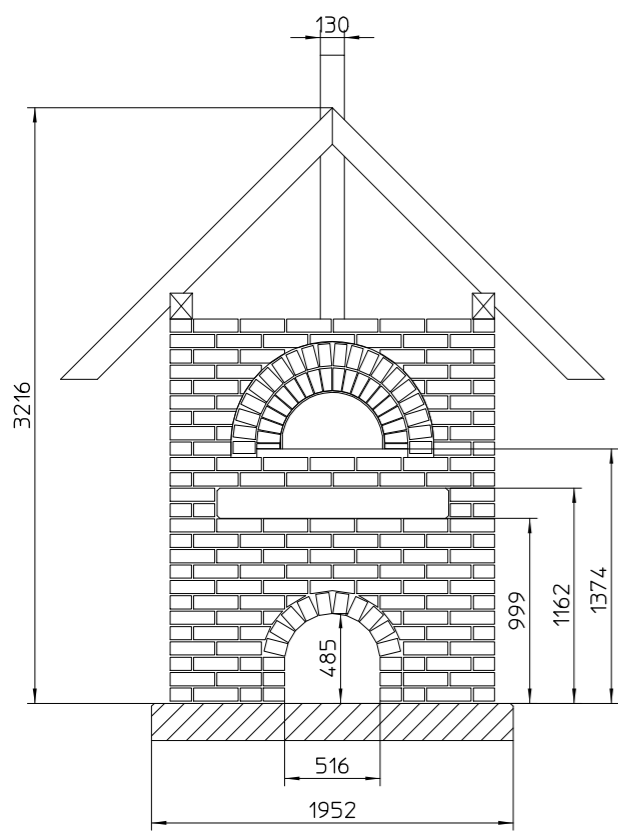

KS Steine Format 240 x 115 x 113 108Stk.  
 KS Steine Format 240 x 115 x 71 18Stk.  
 Klinker Format 240 x 115 x 71 616Stk.

|   |  |   |  |  |  |   |  |  |  |
|---|--|---|--|--|--|---|--|--|--|
| Durch den Auftraggeber verantwortlich geprüft und zur Fertigung freigegeben!<br>Approved by customer! |  | Achtung! Änderungen nach Fertigungsfreigabe gehen zu Lasten des Bestellers!<br>Attention! Changes after confirmation will be charged to customer! |  | Schutzvermerk DIN ISO 9006 beachten<br>Observe protection notices DIN ISO 9006 |  | Maße in Millimeter [mm] / Dimensions in millimetres [mm]<br>All general tolerances according to / General tolerances according to |  | Bewahrt / Preserved                                  |  |
| Ort/Place<br>Datum/Date   |  | Bearb. on<br>Drawn of<br>10.06.2013<br>Gepr. as<br>Prüfer<br>Approved of  |  | Werkstoff / Material<br>Oberfläche / Surface                                   |  | Benennung / Title<br><b>Steinbackofen</b><br><b>Nastulla</b>  |  | Zeichnungsnr. / Drawing No.<br>Index / Rev.<br>- / - |  |
| Unterschrift/Signature Firmenstempel/Stamp  |  | Ind. Änderung<br>Rev./Description of Rev.   |  | Datum<br>Date  |  | Name<br>HÖRMANN KG<br>Brockhagen<br>Hersteller, 17<br>33803 Steinhagen  |  | Maßstab<br>Scale<br>1:20                             |  |
|   |  |   |  |  |  | Format Blatt<br>Size Sheet of<br>A1 1 1   |  | von<br>Sheet of<br>1 1                               |  |
|   |  |   |  |  |  | Ersatz für / Replaces   |  | CAD-System<br>0800                                   |  |